

The United States of America:
Peter Kwasny Inc.
62-64 Enter Lane,
Islandia, NY 11749

Distributed in

Canada by
Peter Kwasny Spraypaint Canada Inc.
2275 Lakeshore Blvd. West, Suite 530
Toronto, ON. M8V 3Y3

Toll free North America
Phone: 1-844-426-6330 / Fax: 1-866-226-6434
order@kwasny.us / service@kwasny.us
www.spraymax.com

SprayMax®
2K Rapid Primer Filler Gray
375 g NET WT. 13.2 oz
Art. Nr. 3680031



Product

Description / Purpose

Universal, quick-drying 2 component primer for high-quality automotive paint jobs.

Properties

- Free from isocyanates and resistant to solvents
- Quick drying (1 hour at 68° F)
- Good sandability
- High filling capacity (up to 4 mil)
- Excellent adhesion, including on bare sheet and galvanized surfaces as well as existing sanded paint finishes
- Can be topcoated with all conventional 1K basecoat and 2K topcoat systems

Material base

Two-component acrylic resins

Colour

Grey

Solid content

46.3 % by weight relating to the diluted paint

EPA Coating Category

ABP Auto Body Primer

PWR Limit 1.55

**CARB Aerosol Rule Coating Category
(01/2017)**

TCC Two Component Coatings

PWR Limit 1.20

Substrate

Steel (cleaned and sanded)

Galvanised steel (hot-galvanised, strip galvanised and electro-galvanised cleaned and sanded)

Soft aluminium (cleaned and sanded)

Various Plastics (cleaned and sanded)

Check compatibility and adhesion first on an unobtrusive area. If necessary prime with SprayMax® 1K Plastic Adhesion Promoter suitable Plastic Adhesion Promotor.

Polyester surfaces (cleaned and sanded)

Old paint and factory paint (cleaned and sanded)

The damaged area must be dry and free of grease and dust and all rust needs to be removed.

Processing

Protection measures



Wear personal protection equipment.
(respiratory mask/gloves/goggles)

For more information, see safety data sheet.

Shake

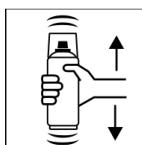

Before activating, shake can thoroughly for 2 minutes from when the mixing balls are heard.

Place red button

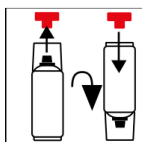

Before activating, shake can thoroughly for 2 minutes from when the mixing balls are heard.

Press red button

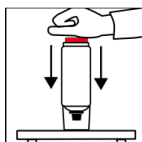

Turn the can upside down and place on a firm surface. Press the red button with the palm of your hand until it clicks into place.

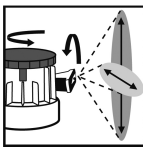
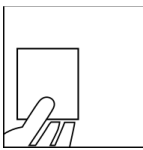
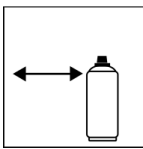
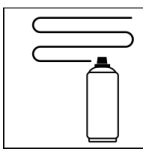
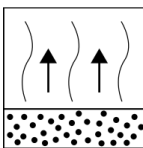
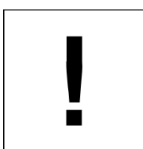
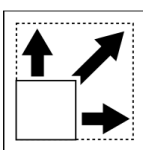
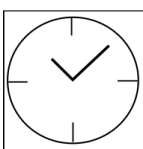
Shake		<p>After activating, shake can again thoroughly for 2 minutes, again from when the mixing balls are heard.</p>
Adjustable Nozzle		<p>Set the variable spray nozzle to the size and pattern of the damage.</p>
Spray to test		<p>After shaking the can, test spray and check compatibility with the surface and the colour.</p>
Spraying distance		<p>6 - 8 inches / 15 - 20 cm</p>
Spray passes		<p>Dry film thickness 2.3 - 3,1 mil (60 - 80 µm) (approx. 2 - 3 spray coats)</p>
Flash-off time		<p>Flash time: approx. 5 - 10 min between each spray coat</p>
Processing conditions		<p>Optimum application at 64° F - 77° F (18° C - 25° C) and a relative humidity from 40 - 50 %.</p>
Coverage		<p>approx. 5.4 - 8.1 sq ft (0.5 - 0.75 m²) / aerosol at approx. 1.2 - 2.0 mil (30 - 50 µm) dry film thickness</p>
Drying		<p>Can be topcoated after approx. 20 min air drying, recoatable wet-in-wet; sandable: 1 hour at 68° F (20° C) 30 min at 140° F (60° C)</p>

The stated values refer to the abovementioned processing conditions. The level of dryness is determined pursuant to DIN 53150.

Continue



IR drying possible,
Respect technical manual

Can be topcoated wet -on-wet with all conventional 1K and 2K topcoats after approx. 20 min.



Wet sanding with P 800

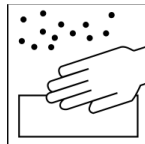

Dry sanding with Excenter and P 400

Pot life

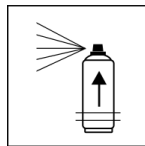

Approx. 24 h at 68° F (20° C) room temperature and a relative humidity of approx. 40 - 50 %.

The processing time depends on the ambient temperature. Higher temperatures reduce the pot life, lower temperatures will prolong it.

Finish

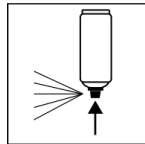

After painting, turn the can upside down and spray the valve until empty.

Additional Information

Shelf Life

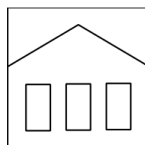

36 months (not activated)

The usage period refers to an unused can that is stored correctly at a temperature of 68° F / 20° C and a relative humidity below 60%. The can must be stored and transported in an upright position in a dry place where it is protected against chemical and mechanical influences. The safety information on the can and all statutory provisions applicable for the storage site must be observed.

Disposal



The completely emptied spray cans must be disposed of in the recycling system. Cans with hardened material must be disposed of as special waste.

**Note**

For professional use only.

Identification, see safety data sheet.

The contents in this technical data sheet were created with great care and reflect our current state of knowledge. They provide the user with application-specific information and do not promise certain properties. The information is non-binding and we accept no liability for its integrity, accuracy and completeness. They do not relieve the user of their duty to check the suitability of our product for the intended purpose. The warnings printed on our labels must be respected. Our brands and patents are protected by copyright. All rights reserved. We reserve the right to update, amend or supplement the content of the information without prior notice.